

DWARKA PROJECT

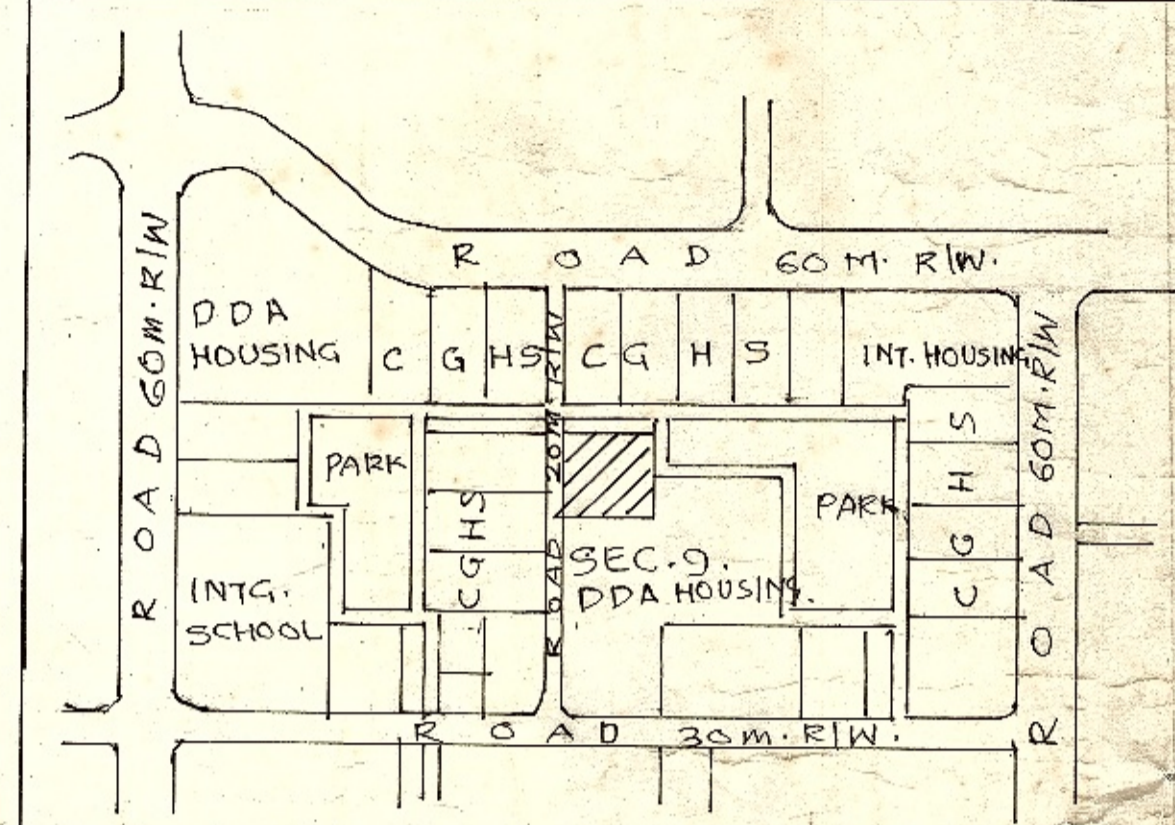

KEY PLAN

AREA STATEMENT

TOTAL AREA OF POCKET = 8992.66 SQM

COMM. ROOM I	660.00 SQM
DISPENSARY	1000.00 SQM.
R.B.	400.00 SQM
COMM. ROOM II	672.60 SQM
ESS EXIST.	148.35 SQM
C.S.C	1198.84 SQM 1124.03 SQ.M.
NURSARY SCHOOL I	800.00 SQM
NURSARY SCHOOL II	800.00 SQM 749.95 SQ.M.
P. S. P PLOT	2296.00 SQM 2300.0 SQ.M.
CIRCULATION	1016.77 SQM

- NOTES:-**
- APPROVED BY COMM. PLG. IN FILE NO. F8(10)94/DWK/HAF/D/PLG DATED 14-2-07 ON PAGE NO. 17 IN DRAWING NO. SEC-9/HAF/97/0030
 - APPROVED PLAN HAS BEEN REVISED ON THE BASIS OF FEASIBILITY REPORT OBTAINED FROM EE/ND8/DDA VIDE LETTER NO. F1(400)/ND8/AE(P)/DDA/658 DT 16-3-98.
 - REVISED PLAN HAS BEEN APPROVED BY DIR.(PLG.)DWK/ITK/UN/ON DT. 18-5-98 AT PAGE NO. 8 IN FILE NO. F8(6)94/SEC-9/HAF PKT-1/DWK
 - REVISED LAYOUT PLAN ON BASIS OF P.T. SURVEY IN FILE NO. F8(6)94/SEC-9/HAF/PKT-1/DWK. AND APPROVED BY COMM. (PLG.) DDA ON PAGE NO. 13 IN FILE NO. F8(6)94/SEC-9/HAF PKT-1/DWK DT. 7-2-2003.

HOUSING AREA FACILITY POCKET-1, SECTOR-9

LAYOUT PLAN REVISED

SCALE 1:500 DRG. NO.

PLG. D MAN ASST. DIRECTOR

JT. DIRECTOR (PLG) DIRECTOR (PLG)

DELHI DEVELOPMENT AUTHORITY

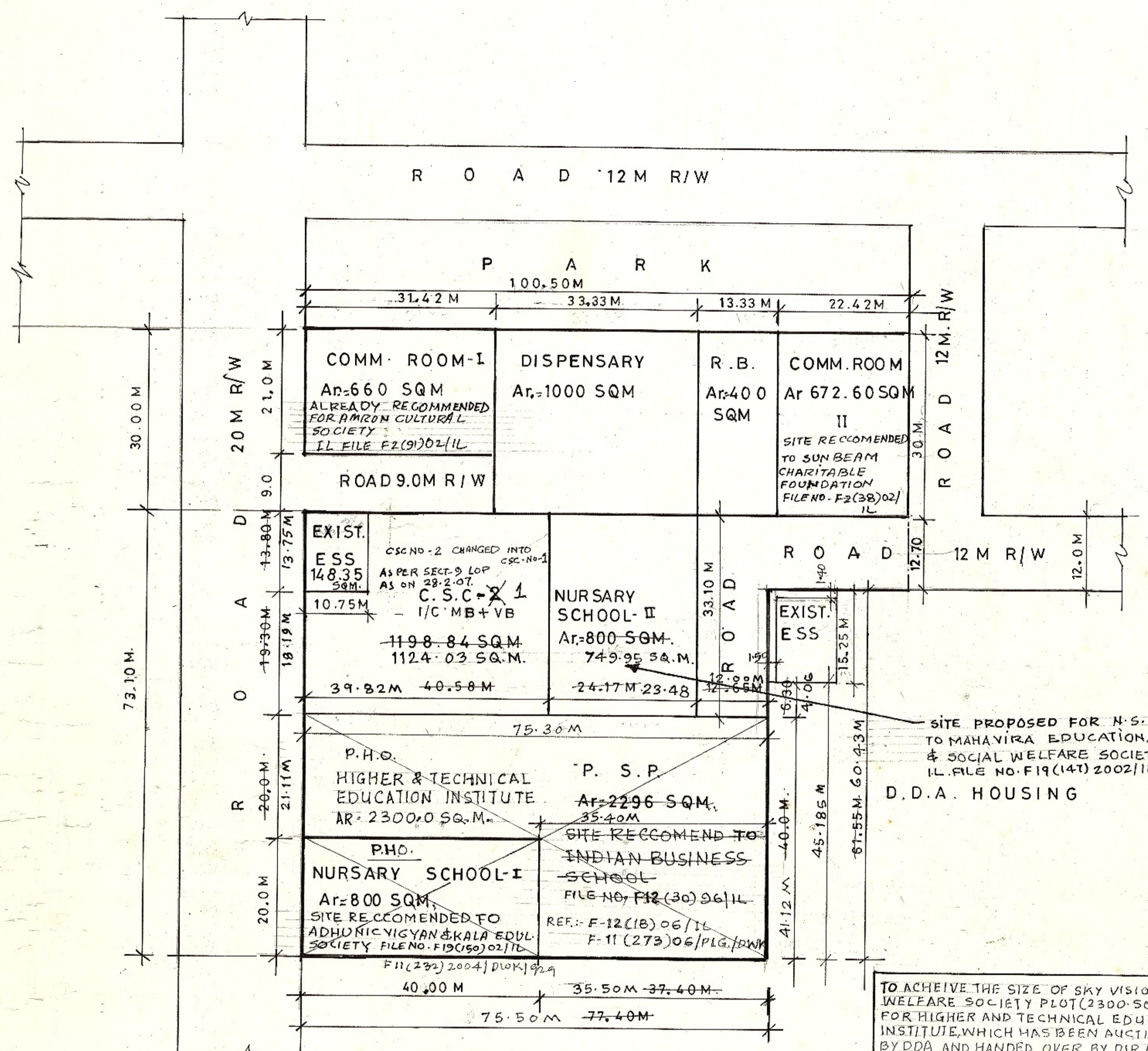

SITE PROPOSED FOR N.S. TO MAHAVIRA EDUCATIONAL & SOCIAL WELFARE SOCIETY IL. FILE NO. F19(147) 2002/IL. D.D.A. HOUSING

TO ACHIEVE THE SIZE OF SKY VISION WELFARE SOCIETY PLOT (2300 SQ.M.) FOR HIGHER AND TECHNICAL EDUCATION INSTITUTE, WHICH HAS BEEN AUCTIONED BY DDA AND HANDED OVER BY DIR. (PLG.) OFFICE ON 2-1-07, MODIFICATIONS HAS BEEN DONE ON THE SIZES OF THE ADJESNT C.S.C-II & N.S-II PLOTS. THE SAME HAS BEEN APPROVED BY THE COM. (PLG.) ON 8-02-07 VIDE FILE NO. E-11(273)06/PLG./DWK AT PAGE NO. 20/N.

- THE PLAN IS SUBJECT TO MODIFICATIONS WITHIN THE FRAMEWORK OF MASTER PLAN/ ZONAL PLAN.
- IT IS FOR PLANNING PURPOSE & IS NOT FIT TO BE PRODUCED IN THE COURT OF LAW FOR PROPERTY DISPUTES.
- ALL DIMENSIONS & AREA GIVEN IN THE PLAN ARE SUBJECT TO CONFIRMATION OF OWNERSHIP/ALLOTMENT STATUS AND DEMARCATIONS/FEASIBILITY REPORT FROM THE DDA LANDS & ENGINEERING WING RESPECTIVELY.

D.D.A. HOUSING